



Our
showroom
-
The
Solarlux
Forum



Our Headquarter



The Company | Development

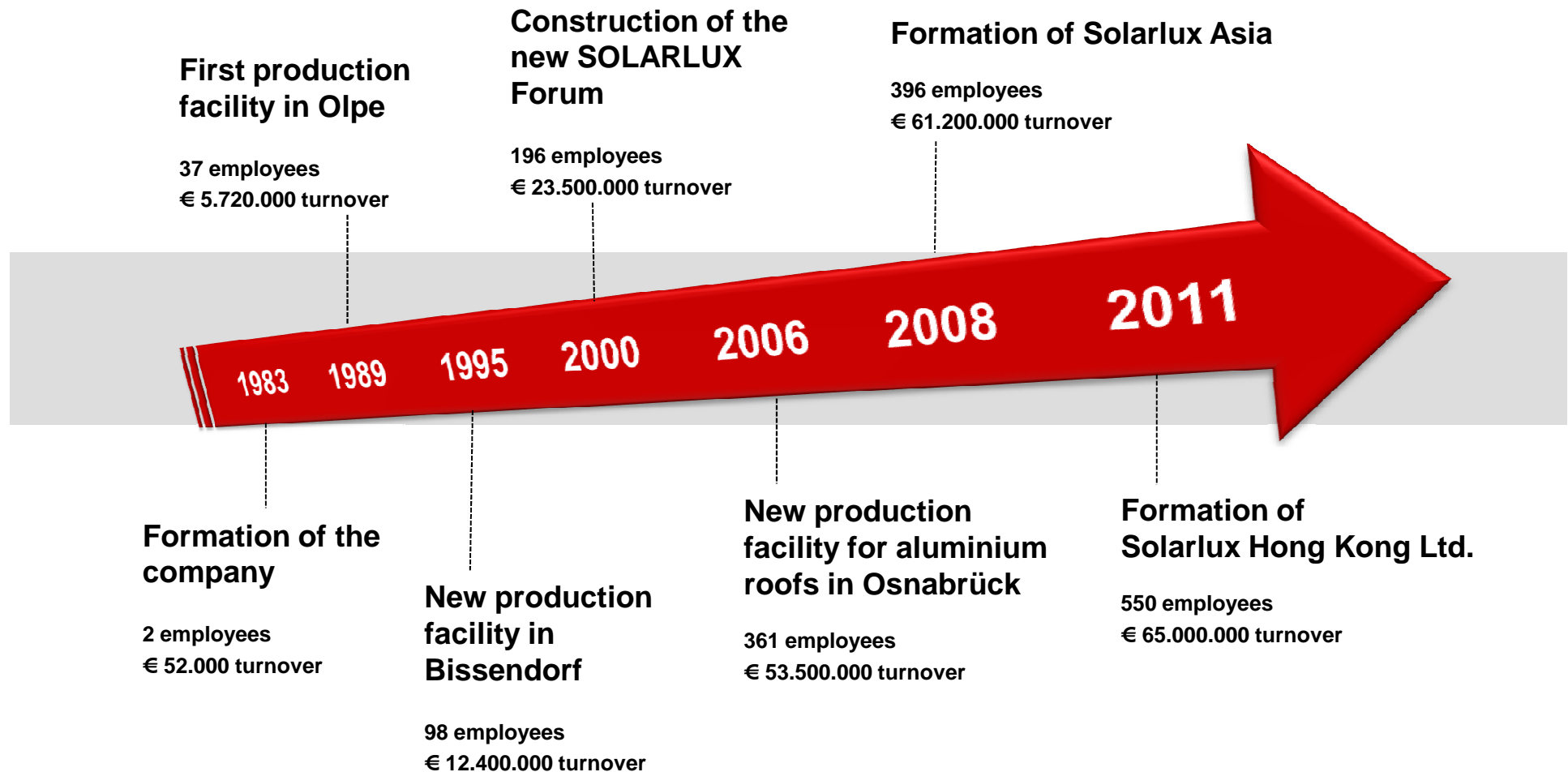

The Company | Our Mission

Our Mission: Development and production of folding door systems which satisfy and exceed the highest expectations in order to help our customers solve their challenges

**Company
owners:**

Herbert Holtgreife
+
Stefan Holtgreife



Solarlux HQ

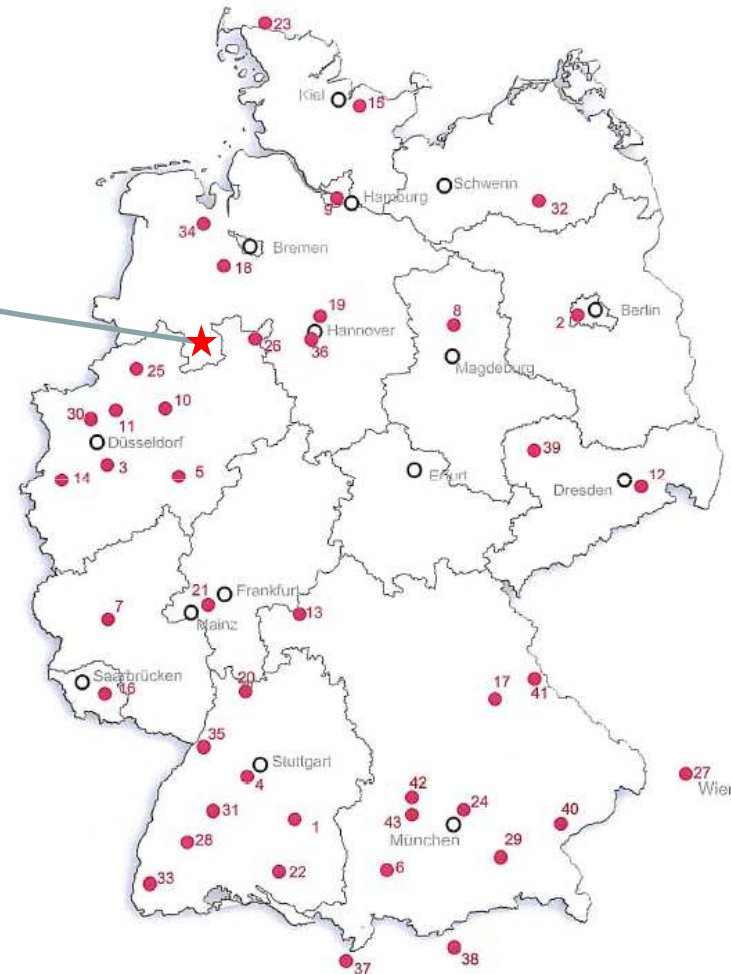

GERMANY
50 active partner
1.000 metal workers



- | | | | | |
|--------------------------------|-----------------------------------|---------------------------|----------------------------------|-----------------------------|
| 1. SOLARLUX Germany | 9. Con Buenos Resultados, Majorca | 17. Technostroj, Bulgaria | 25. Nana Wallsystems, USA | 33. Chase Windows, China |
| 2. SOLARLUX UK | 10. SOLARLUX Office Austria | 18. Holtov Ltd., Ukraine | 26. Nana Manufacturing, USA | 34. Reinchen, Taiwan |
| 3. SOLARLUX Netherlands | 11. Euromat Japan | 19. Profillack, Sweden | 27. SBM, Brasil | 35. Unisolar, Korea |
| 4. SOLARLUX Switzerland | 12. SOLARLUX Middle East | 20. Willab, Sweden | 28. Sunplan Systems, Southafrica | 36. U.T.G., Syria |
| 5. SOLARLUX Office Scandinavia | 13. Alco Beldan Group, UK | 21. Nor-Int, Norway | 29. Doors & Doors, India | 37. DEMA, Poland |
| 6. SOLARLUX Office Spain | 14. Soprofen, France | 22. Win Door, Denmark | 30. Altech, Malaysia | 38. Häfele, Australia |
| 7. Servydrill, Spain | 15. Alkam Alu, Slovenia | 23. Lejo, Finland | 31. Raum Geometrie, Russia | 39. SOLARLUX Office Bangkok |
| 8. Jorkon, Spanien | 16. Hladik, Czech Republic | 24. VAR, Italy | 32. Vento, Singapore | |

WORLDWIDE

Folding doors | Where to use



Idea: folding wall integrated in curtain walling

Folding doors | Where to use



Idea: indoor and outdoor areas converge, space restrictions are lifted

Folding doors | Where to use



Idea: an open conservatory to enjoy your garden



Folding doors | Where to use



Idea: let nature inside



Idea: folding door instead of a window to create a large opening

Folding doors | Where to use



Idea: combine inside and outside

Folding doors | Where to use



Idea: combining/separating rooms and areas

- Solarlux Systems - General characteristics

FOLDING WALL

I SL 35	framed glazing, not thermally broken
I SL 45	framed glazing, not thermally broken
I SL 60	framed glazing, thermally broken and not broken
I SL 70e	framed glazing, thermally broken
I SL 80/SL 81	framed glazing, thermally broken
I SL 82 structural glazing	framed glazing, thermally broken
I SL 65 / SL 66 Wood	framed glazing, thermally broken
I SL 67 Wood-Aluminium	framed glazing, thermally broken
I SL 60 HSW	horizontal sliding wall, thermally broken

General characteristics of Solarlux systems

1. German made (license production: German profiles and hardware)
 2. Material choices: aluminium, wood and wood-aluminium
 3. Maximal panel sizes: 3500mm high, 1200mm wide
 4. Maximal opening width: 14 meter
 5. Free configuration (inward/outward, folding direction)
 6. All hardware and the running tracks are concealed
 7. Top-running or bottom-rolling
 8. Floor track choices: flush or with raised sill
 9. With or without thermal break
 10. Width and height of panels can be adjusted after installation
 11. Wind loads, water tightness independently tested in the EU and USA
-

- Solarlux SL 60 - Characteristics

Solarlux SL 60 | System characteristics



Configurations SL 60e

Folding façade

View from inside

SL 60e „u“ I - 3R

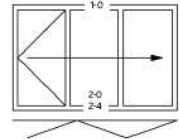

Details for floor-mounted folding façade

SL 60e „o“ I - 3R

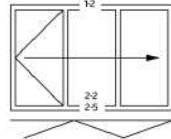

Details for top hung folding façade

- ① primary panel
- ② secondary panel

I - 3R

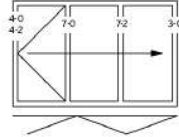

I - 3L 3R

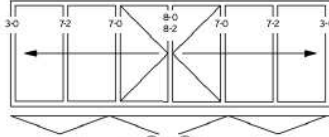

or

I - 2L 1R

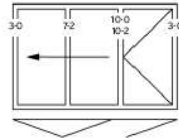

I - 5R

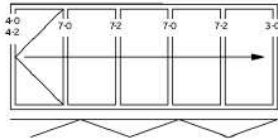

I - 4R

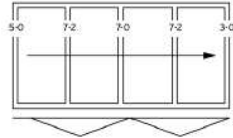

I - 2L 3R

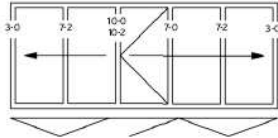

I - 2L 2R

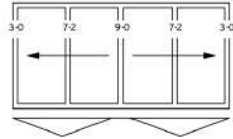

I - 1L 3R

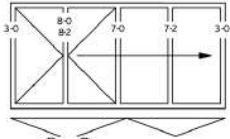

or

01/2008 - Subject to technical changes

Configurations - 1



Configurations SL 60e

Folding façade

View from inside

Folding façade with transom

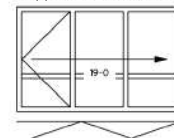

Folding façade with overhead panel

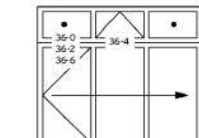

Folding façade on parapet

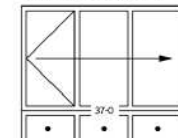

Left / right floating models are only available for top hung folding façades.

I - 4LR

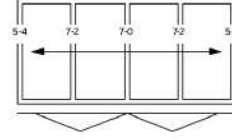

A - 4LR

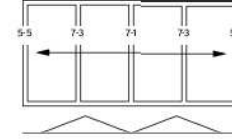

- ① primary panel
- ② secondary panel

I - 2LR 2LR

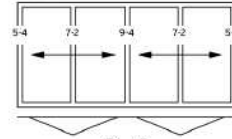

A - 2LR 2LR

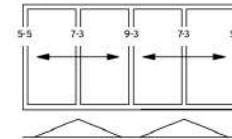

I - 1L 4LR Swing

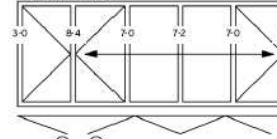

A - 1L 4LR Swing

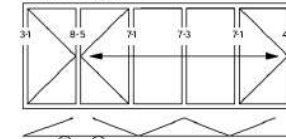

I - 2LR 3R

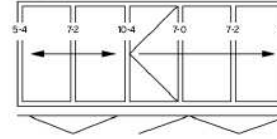

A - 2LR 3R

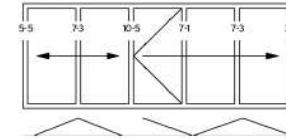

01/2008 - Subject to technical changes

Configurations - 3



Height adjustments

Once in site, the folding façade can be easily adjusted in height by about 6 mm, which is important if setting of the building occurs



Engineered

Stainless steel runners and tracks ensure effortless sliding action of the folding façade

Easy to open and to close



Stability

Espagnolettes with 24 mm throw lock the panels into the top and bottom track of the frame ensuring they withstand gales and afford high security.



Width adjustment

The width of the panels can be adjusted easily by adapting the hinges (patented) with a screwdriver

Solarlux SL 60 | System characteristics



Example 1
5-60-01-x

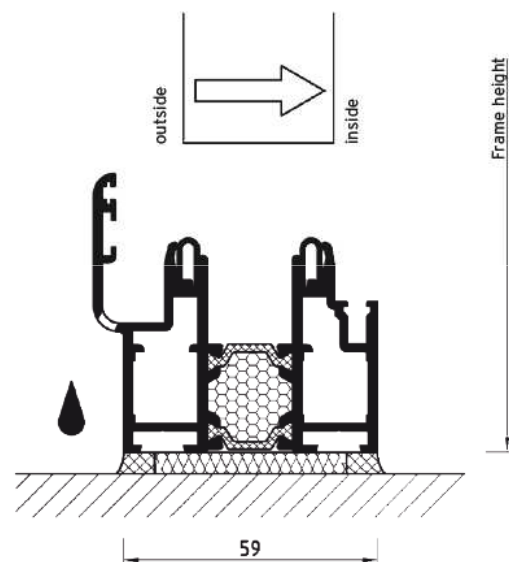

Example 2
5-60-01-x

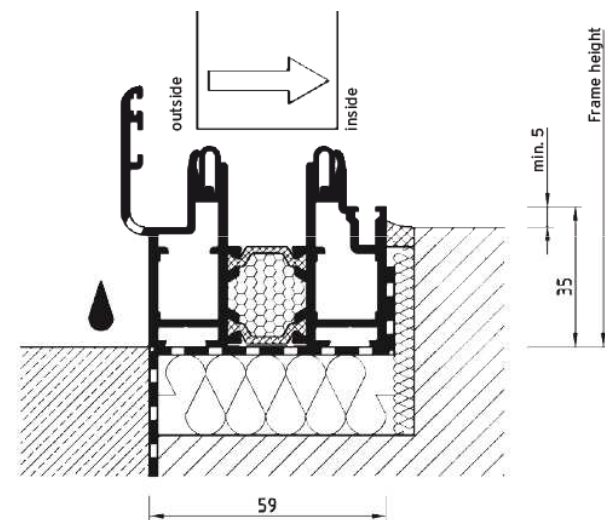

Solarlux SL 60 | System characteristics

Example 4
5-60-01-x

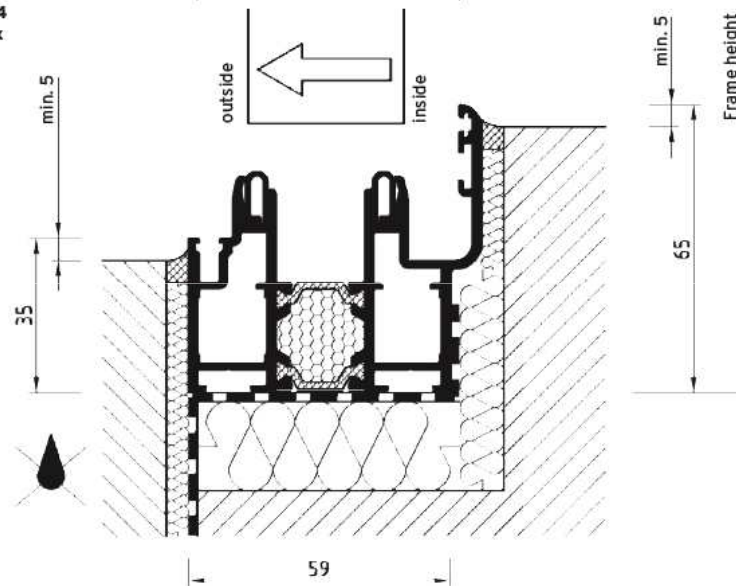

Example 3
5-60-01-x

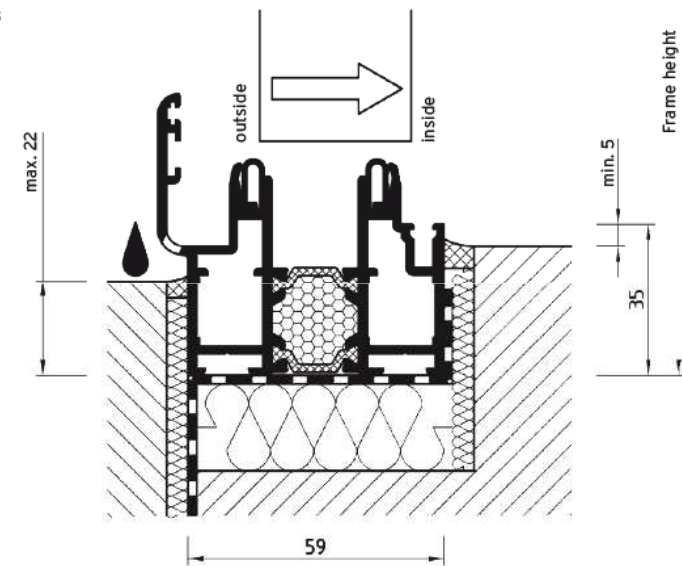

Solarlux SL 60 | System characteristics



Example 5
5-60-23-x

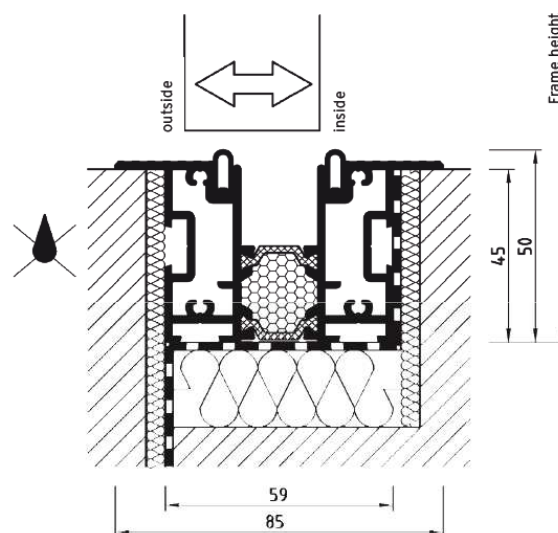

Solarlux SL 60 | System characteristics



Foldable corner
post



Solarlux SL 60 | System characteristics



Evidence of Performance Resistance to wind load Watertightness Air permeability Test Report 102 33120e This is a translation of Test Report 102 33120 dated 19 March 2007														
Client Solarlux Aluminium Systeme GmbH Gewerbepark 9-11 49143 Bissendorf, Germany	Basis EN 1026 : 2000-06 EN 1027 : 2000-06													
<table border="1"> <tr> <td>Product</td> <td>Folding door</td> </tr> <tr> <td>Designation</td> <td>SL 60c</td> </tr> <tr> <td>Construction projects</td> <td>SD-Tower, Mumbai</td> </tr> <tr> <td>Overall dimensions (W x H)</td> <td>3453 mm x 2400 mm</td> </tr> <tr> <td>Building project</td> <td></td> </tr> <tr> <td>Frame material</td> <td>Metal profiles</td> </tr> </table>	Product	Folding door	Designation	SL 60c	Construction projects	SD-Tower, Mumbai	Overall dimensions (W x H)	3453 mm x 2400 mm	Building project		Frame material	Metal profiles	Representation 	
Product	Folding door													
Designation	SL 60c													
Construction projects	SD-Tower, Mumbai													
Overall dimensions (W x H)	3453 mm x 2400 mm													
Building project														
Frame material	Metal profiles													
Watertightness – EN 12208 Class 9A Air permeability – EN 12207 Class 4 Resistance to wind load ¹⁾ Deflection measurement at ± 2300 Pa Results see test record (page 18 and 19) Safety load at up to ± 3800 Pa		Instruction for use This test report serves to demonstrate the above characteristics. 1) According to the manufacturer, this window originates from the building project SD-Tower, Mumbai and was selected by the client as representative component. Validity The data and results refer solely to the tested and described specimen. The test does not allow any statement to be made on further characteristics of the present structure regarding performance and quality, in particular the effects of weathering and ageing.												
¹⁾ Resistance to wind load was not tested according to the relevant European test standards but as specified by the client. Therefore, classification according to European standards is not possible.		Notes on Publication The Ift-Guidance Sheet "Conditions and Guidance for the Use of Ift Test Documents" applies.												
Ift Rosenheim 19 March 2007 Jörn Peter Lass, Dipl.-Ing. (FH) Head of Testing Department Ift Centre Windows & Facades		Markus Egli, Dipl.-Ing. (FH) Testing Engineer Ift Centre Windows & Facades												
Ift Rosenheim GmbH Geschäftsführer: Dipl.-Ing. (FH) Ulrich Biederath DI, Justus Pätz	Theodor-Geis-Straße 7-8 D-85035 Rosenheim Tel. +49 (0)89 31 0201-0 Fax +49 (0)89 31 0201-200 www.ift-rosenheim.de	Str. 63026 Rosenheim A5 Traunstein, HRB 14769 Sparwasser Rosenheim Kto. 3532 GLZ 711 500 00												

Independent
German and
American test
certificates

SL 60 System Summary

1. Profiles, hardware and gasket are especially developed for use in folding door systems
2. Slender profiles (only 130mm where panels meet)
3. All hardware and the running tracks are concealed
→ no soiling, easy maintenance
4. Width and height of panels can be adjusted after installation
5. Wind loads, water tightness etc. have been tested by independent institutes in the EU and USA
6. 24mm deep locking rods and 3-point locking for high security

Client Benefits

1. High Quality Products from the World Leading Producer of Folding Doors
→ Folding is what we do!
 2. Chosen by famous architects like David Libeskind and Sir Norman Foster
 3. Solutions developed to fit your requirements, NOT a one-fits-all approach
→ We solve your problems and satisfy your customers!
 4. On-site technical support by Solarlux Hong Kong office
 5. Installation support by German Solarlux installation team
- The best of 30 years experience in folding door development**

Solarlux SL 60 | Projects

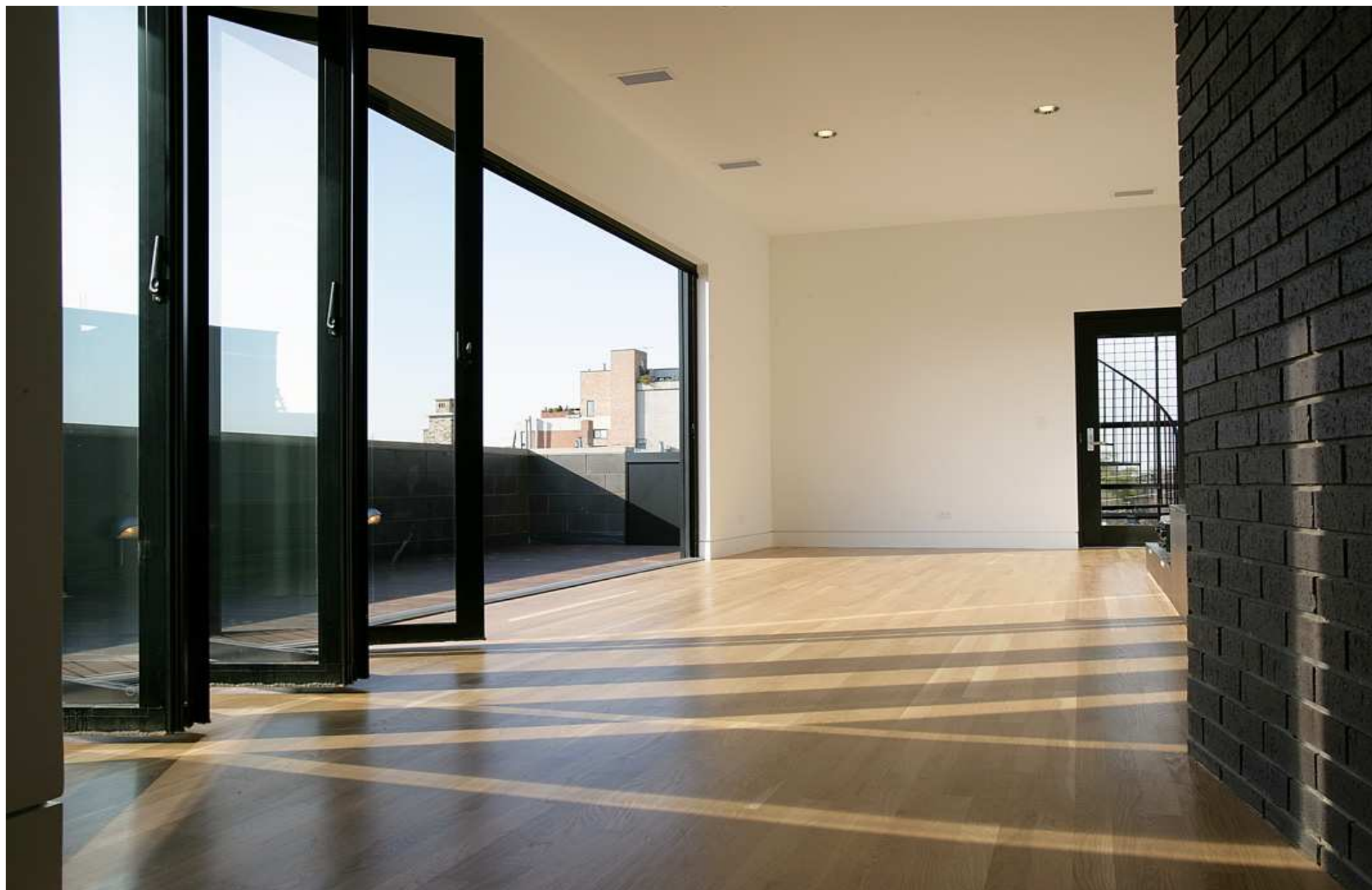

USA





Netherlands



Nether-
lands



USA



Nether-
lands



USA

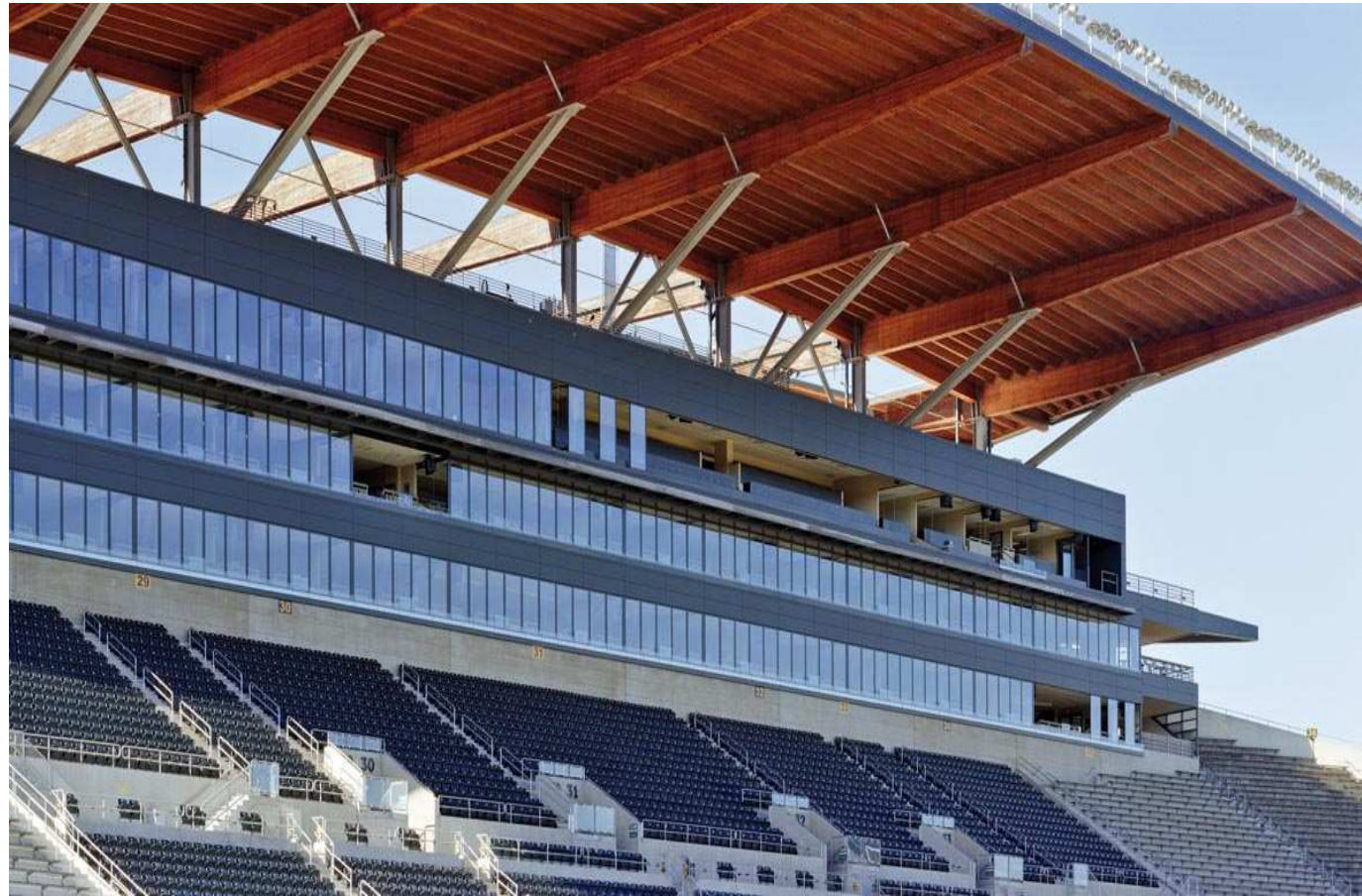

- Solarlux in Asia - Projects

SD Towers

- ✓ 2 towers
- ✓ height: 210 m
- ✓ floors: 60
- ✓ sets of folding doors: 250
- ✓ panel size: 2750 x 800
- ✓ wind load: 2.7 kPa (lower floors)
- ✓ wind load: 3.8 kPa (upper floors)
- ✓ water resistance: 600 Pa



The Cliveden

- ✓ 4 towers
- ✓ height: 120 m
- ✓ floors: 27
- ✓ sets of folding doors: 200
- ✓ panel size: 2900 x 900 mm
- ✓ wind loads: 2.2 kPa
- ✓ water resistance: 600 Pa



Solarlux SL 70 | Singapore – The Cliveden



Solarlux SL 70 | Singapore – The Cliveden

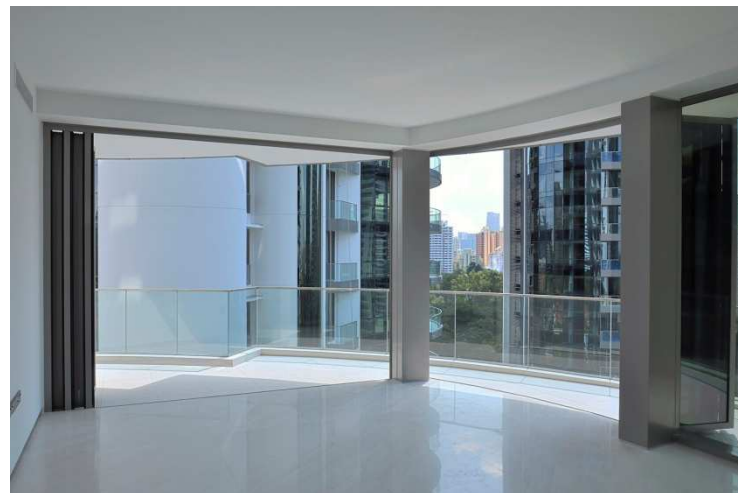

Solarlux SL 70 | Singapore – The Cliveden

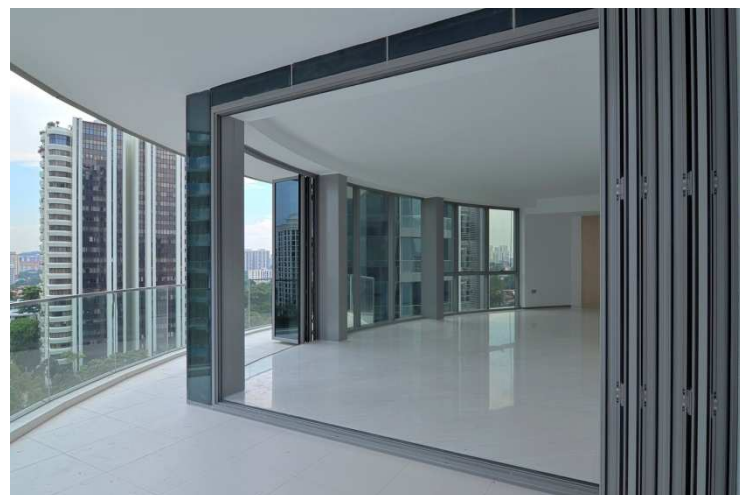

Solarlux SL 70 | Singapore – The Cliveden



Solarlux SL 70 | Singapore – The Cliveden

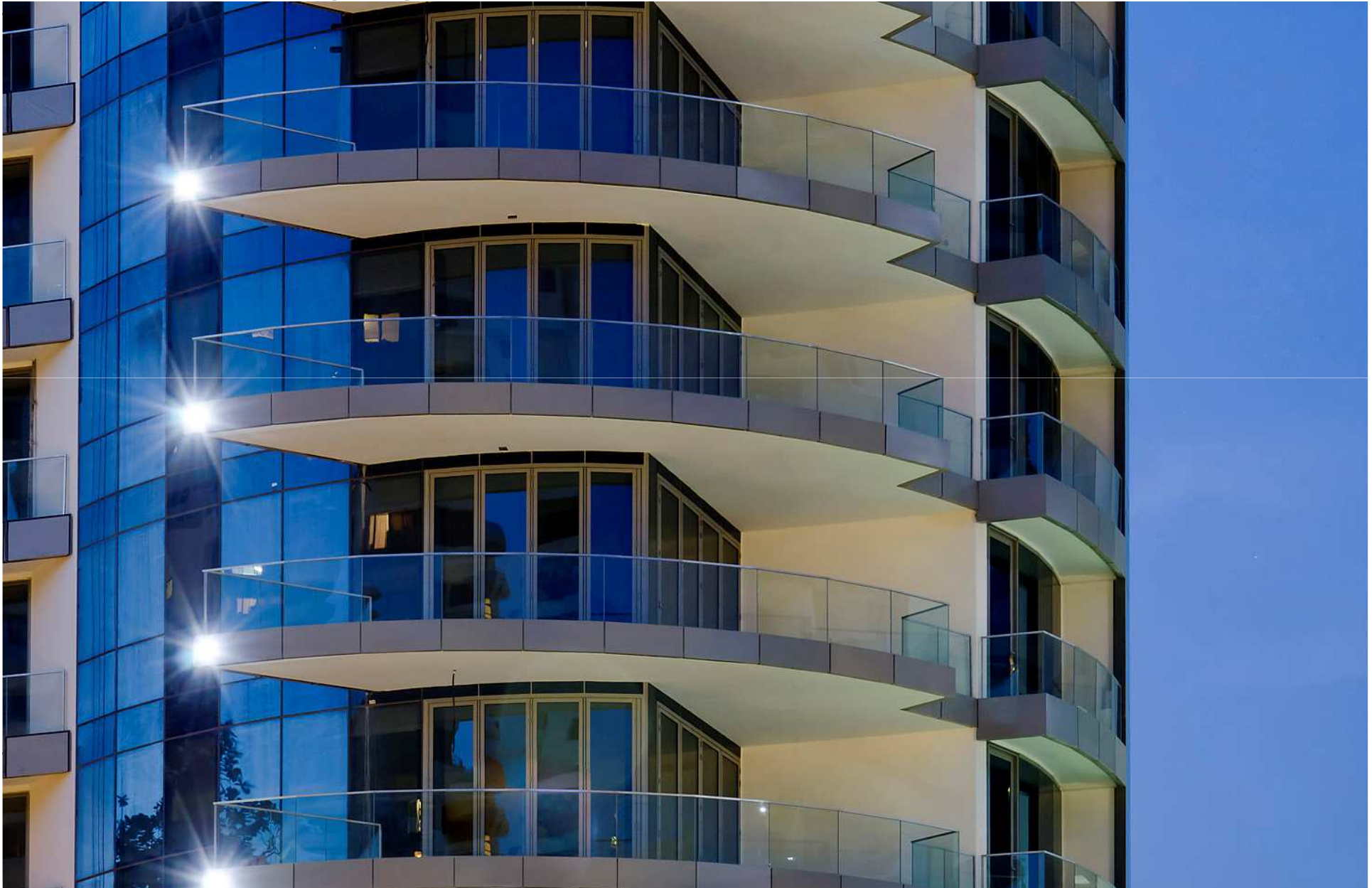

Reflections

- ✓ 6 towers
- ✓ height: 160 m
- ✓ floors: 42
- ✓ sets: 180
- ✓ panel: 2700x800 mm
- ✓ wind load: 2.45 kPa
- ✓ water res.: 600 Pa
- ✓ Architect:
Daniel Libeskind



Solarlux SL 60 | Singapore – Reflections





**Thank you very much
for your time !**